



Commercial Service Parts

UPRIGHT CONVECTION OVEN (HUCO)

Hestan Commercial Corporation
3375 E. La Palma Ave.
Anaheim, CA 92806
(888) 905-7463

RETAIN THIS FOR FUTURE REFERENCE

Revised: May 15, 2020

UPRIGHT CONVECTION OVEN - SERVICE PARTS DIAGRAM

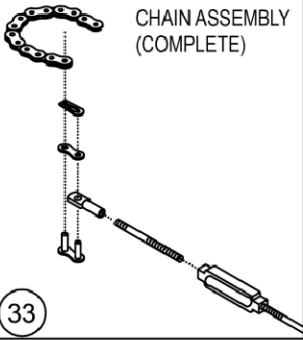

33

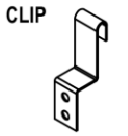
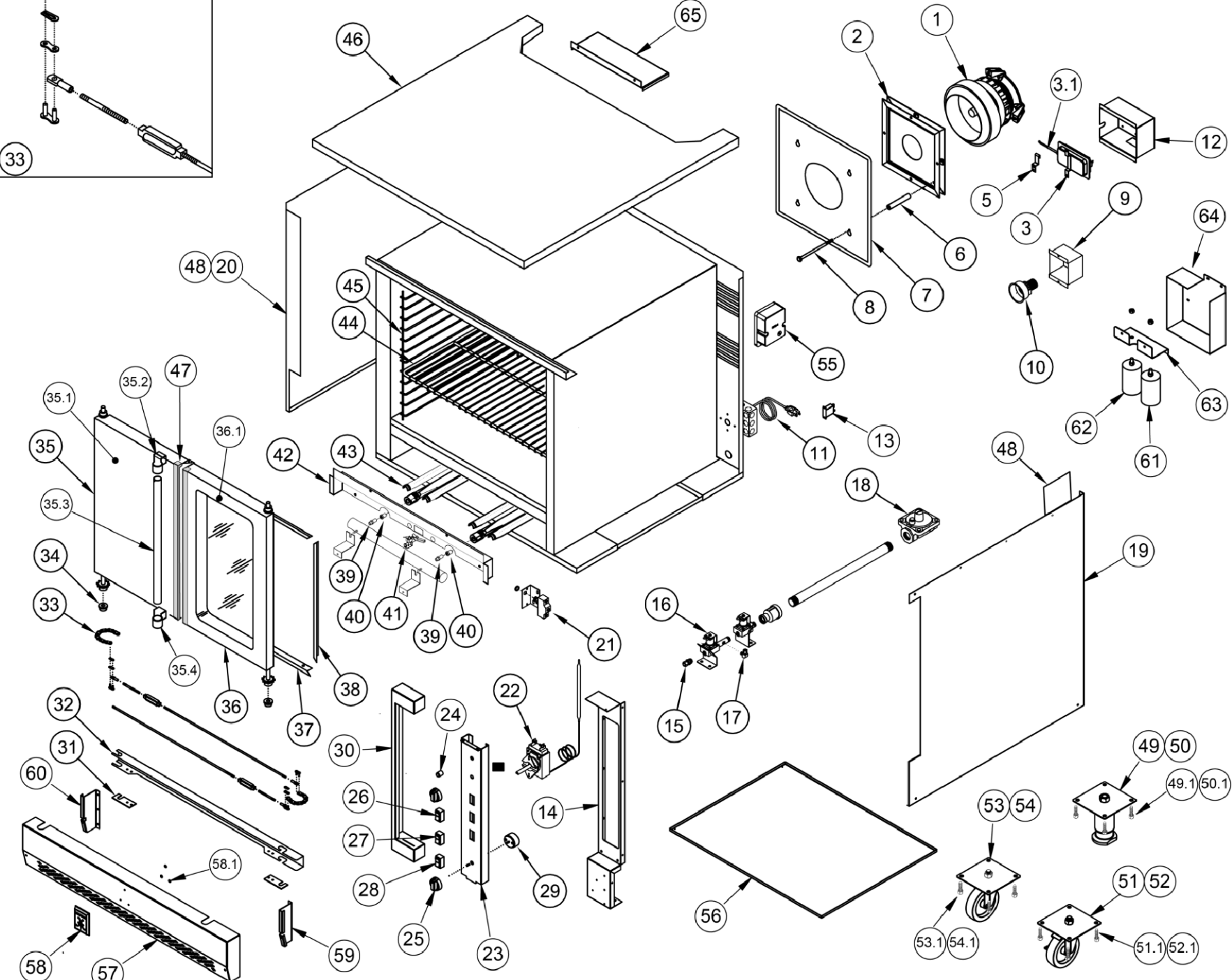

5

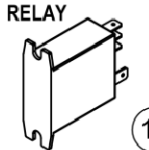

13

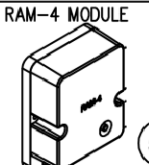

55



15

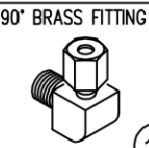

17

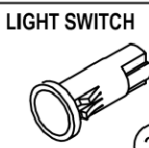

24



39



40

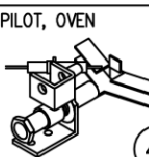

41

Not shown: 032248 WIRING HARNESS, HUCO

UPRIGHT CONVECTION OVEN - SERVICE PARTS LIST

Item No.	Part No.	DESCRIPTION	HUCOD	HUCOL	HUCOR	HUCOS	HUCOD2	HUCOL2	HUCOR2	HUCOS2
			QTY	QTY	QTY	QTY	QTY	QTY	QTY	QTY
1	024619	MOTOR, BLOWER, LARGE, UPRIGHT CONVECTION OVEN	1	1	1	1	2	2	2	2
2	029425	SERVICE, BLOWER MOTOR MOUNTING FRAME, HUCO	1	1	1	1	2	2	2	2
3	024443	SWITCH, SENSING, AIR PRESSURE, CLEVELAND CTRLS	1	1	1	1	2	2	2	2
3.1	024463	HOSE, PRESSURE SENSOR, UPRIGHT CONV. OVEN	1	1	1	1	2	2	2	2
4	029431	SERVICE, SNORKEL TUBE WELD ASSY, HUCO	1	1	1	1	2	2	2	2
5	024462	SERVICE, HOSE CLIP, PRESSURE SENSOR, HUCO	1	1	1	1	2	2	2	2
6	029413	SERVICE, BLOWER SPACER TUBE	4	4	4	4	8	8	8	8
7	029414	SERVICE, BLOWER BAFFLE COVER	1	1	1	1	2	2	2	2
8	029415	SERVICE, SHOULDER BOLT (1/4-20 X 4")	4	4	4	4	8	8	8	8
9	029416	SERVICE, LIGHT BULB COVER R/H	1	1	1	1	2	2	2	2
	029418	SERVICE, LIGHT BULB COVER L/H	1	1	1	1	2	2	2	2
10	029417	SERVICE, LIGHT BULB (COMPLETE)	2	2	2	2	4	4	4	4
11	029419	SERVICE, POWER CORD 6'	1	1	1	1	2	2	2	2
12	024464	SERVICE, PRESSURE SWITCH COVER	1	1	1	1	2	2	2	2
13	024944	ELECTRICAL RELAY	1	1	1	1	2	2	2	2
14	029744	SERVICE, CONTROL PANEL SUPPORT, HUCO	1	1	1	1	2	2	2	2
15	029423	SERVICE, STRAIGHT FITTING 3/8 CC X 3/8 NPT, HUCO	1	1	1	1	2	2	2	2
16	029424	SERVICE, SOLENOID VALVE, HUCO	2	2	2	2	4	4	4	4
17	000832	ELBOW, (BRASS), 1/8 NPTM X 1/4 CC	1	1	1	1	2	2	2	2
18	002965	REGULATOR, STRAIGHT-THRU, 3/4"NPT, NG	1	1	1	1	2	2	2	2
	004161	REGULATOR, STRAIGHT-THRU, 3/4"NPT, LP	1	1	1	1	2	2	2	2
19	029426	SERVICE, SIDE PANEL, RIGHT ACCESS, HUCO	1	1	1	1	2	2	2	2
20	029428	SERVICE, SIDE PANEL, LEFT SIDE, HUCO	1	1	1	1	2	2	2	2
21	029429	SERVICE, DOOR SWITCH, HUCO	1	1	1	1	2	2	2	2
22	029430	SERVICE, THERMOSTAT, HUCO	1	1	1	1	2	2	2	2
23	022554	PANEL, CONTROL, ETCHED, UPRIGHT CONVECTION OVEN	1	1	1	1	2	2	2	2
24	027107	LIGHT, INDICATOR, NEON AMBER, 125 V, UPRIGHT CONV. OVEN	1	1	1	1	2	2	2	2
25	023693	KNOB, CONTROL	2	2	2	2	4	4	4	4
26	029420	SERVICE, SWITCH, OVEN LIGHTS, HUCO	1	1	1	1	2	2	2	2
27	029421	SERVICE, SWITCH, OVEN FAN, HUCO	1	1	1	1	2	2	2	2
28	029422	SERVICE, SWITCH, POWER, 3-POSITION, HUCO	1	1	1	1	2	2	2	2
29	029730	SERVICE, TIMER, MANUAL, HUCO	1	1	1	1	2	2	2	2
30	029686	TRIM, CONTROL PANEL, UPRIGHT CONV. OVEN	1	1	1	1	2	2	2	2
31	029731	SERVICE, BUSHING HOLDER, HUCO	2	2	2	2	4	4	4	4
32	029732	SERVICE, CHANNEL, SPROCKET SUPPORT, HUCO	1	1	1	1	2	2	2	2
33	031757	CHAIN ASSEMBLY, COMPLETE, UPRIGHT CONVECTION OVEN	1	1	1	1	2	2	2	2

Item No.	Part No.	DESCRIPTION	HUCOD	HUCOL	HUCOR	HUCOS	HUCOD2	HUCOL2	HUCOR2	HUCOS2
			QTY	QTY	QTY	QTY	QTY	QTY	QTY	QTY
34	029733	SERVICE, BUSHING, 1/2 ID X 5/8 OD, HUCO	4	4	4	4	8	8	8	8
35	030157	SERVICE, DOOR ASSY, SOLID, LEFT, HUCO	-	-	1	1	-	-	2	2
	030157-XX*	SERVICE, DOOR ASSY, SOLID, LEFT, HUCO, COLORED								
	030155	SERVICE, DOOR ASSY, WINDOW, LEFT, HUCO	1	1	-	-	2	2	-	-
	030155-XX*	SERVICE, DOOR ASSY, WINDOW, LEFT, HUCO, COLORED								
35.1	022823	SERVICE, DOOR SKIN, SOLID, LEFT, HUCO	-	-	1	1	-	-	2	2
	022823-XX*	SERVICE, DOOR SKIN, SOLID, LEFT, HUCO, COLORED								
	029879	SERVICE, DOOR SKIN, WINDOW, LEFT, HUCO	1	1	-	-	2	2	-	-
	029879-XX*	SERVICE, DOOR SKIN, WINDOW, LEFT, HUCO, COLORED								
35.2	000704	ENDCAP, HANDLE, RH, SM (UPPER MOUNT)	1	1	1	1	2	2	2	2
35.3	022827	HANDLE, DOOR, UPRIGHT CONVECTION OVEN	1	1	1	1	2	2	2	2
35.4	000463	ENDCAP, HANDLE, LH, SM (LOWER MOUNT)	1	1	1	1	2	2	2	2
36	030156	SERVICE, DOOR ASSY, SOLID, RIGHT, HUCO	-	1	-	1	-	2	-	2
	030156-XX*	SERVICE, DOOR ASSY, SOLID, RIGHT, HUCO, COLORED								
	030158	SERVICE, DOOR ASSY, WINDOW, RIGHT, HUCO	1	-	1	-	2	-	2	-
	030158-XX*	SERVICE, DOOR ASSY, WINDOW, RIGHT, HUCO, COLORED								
36.1	016579	SERVICE, DOOR SKIN, SOLID, RIGHT, HUCO	-	1	-	1	-	2	-	2
	016579-XX*	SERVICE, DOOR SKIN, SOLID, RIGHT, HUCO, COLORED								
	029882	DOOR SKIN, RIGHT SIDE, WINDOW	1	-	1	-	2	-	2	-
	029882-XX*	DOOR SKIN, RIGHT SIDE, WINDOW, COLORED								
37	029734	SERVICE, DOOR GASKET, TOP/BOTTOM, HUCO	2	2	2	2	4	4	4	4
38	029735	SERVICE, DOOR GASKET, SIDE, HUCO	2	2	2	2	4	4	4	4
39	032161	ORIFICE ADAPTER	2	2	2	2	4	4	4	4
40	000293-36	ORIFICE HOOD #36 (BRASS), NG, 35,000 BTU	2	2	2	2	4	4	4	4
	000293-50	ORIFICE HOOD #50 (BRASS), LP, 35,000 BTU	2	2	2	2	4	4	4	4
41	029737	SERVICE, OVEN PILOT, NG, HUCO (w/igniter)	1	1	1	1	2	2	2	2
	029738	SERVICE, OVEN PILOT, LP, HUCO (w/igniter)	1	1	1	1	2	2	2	2
42	029739	SERVICE, OVEN FRONT BAFFLE, HUCO	1	1	1	1	2	2	2	2
43	029740	SERVICE, U-BURNER, 35000 BTU, HUCO	2	2	2	2	4	4	4	4
44	029741	SERVICE, COOKING RACK, HUCO	5	5	5	5	10	10	10	10
45	029742	SERVICE, RACK GUIDES, HUCO	2	2	2	2	4	4	4	4
46	029743	SERVICE, LINER, TOP, HUCO	1	1	1	1	2	2	2	2
47	026098	DOOR TRIM - RIGHT DOOR (PAINTED UNITS ONLY)	1	1	1	1	2	2	2	2
	026361	DOOR TRIM - LEFT DOOR (PAINTED UNITS ONLY)	1	1	1	1	2	2	2	2
48	029427	SERVICE, SPACER PANEL, REAR, HUCO	2	2	2	2	4	4	4	4
49	031774	SERVICE, 6" LEG ASSY	4	4	4	4	-	-	-	-
49.1	013958	SERVICE, HB, 1/4-20 X 1.0, SS, PKG 8	2	2	2	2	-	-	-	-
50	031773	SERVICE, LEG ASSEMBLY, ADJUSTABLE, UPRIGHT CONVECTION OVEN	-	-	-	-	4	4	4	4
50.1	031755	SERVICE, HB, 3/8-16 X 1.0, SS, PKG 4	-	-	-	-	4	4	4	4
51	001227	CASTER, SWIVEL, ADJUSTABLE, 3", W/ BRAKE	2	2	2	2	-	-	-	-

